

Ball-bearing Lifting Point

BLP

The Gunnebo Industries lifting point range provide a solution for every lifting and rigging operation, enabling improved operational efficiency. To choose the right lifting point for an operation can be a challenge, since most lifting points can be used for several purposes. Safety is our highest priority, therefore has each sold DLP been proof loaded 2.5 times the WLL.

The Ball-bearing Lifting Point (BLP) is a very versatile lifting point and suits most applications. The ball-bearing in the BLP allow the load to be easily rotated during the lift, which is especially good when maintenance is needed on heavy tools and other types of equipment. If the load surface is sensitive to impacts or scratches, the BLP is a good choice as it builds out from the load preventing the lifting equipment to cause damage. The added distance between ring and load makes the BLP an excellent choice for press tools, allowing tools to be turned and tilted. The housing (RFID prepared) of the BLP is in-house drop-forged for increased strength and has a hexagon shape for easy mounting and dismounting.



Prevents damages on load surface

- The BLP builds out from the load preventing the lifting equipment to cause damage.

Can be turned & tilted

- The added distance between ring and load makes the BLP an excellent choice for press tools, as it allows tools to be turned and tilted.

Rotation during lift

- The ball-bearing in the BLP allow the load to be rotated easily during the lift.
- Facilitates maintenance.

Applications where the BLP is perfectly suited

✓ Angular lift

In cases where both tilting and rotation under heavy load with a multiple legged sling is required (e.g. turning an object from one side to the other) the BLP is the only choice. The stable base handles torque excellently and the ballbearing make sure that the lifting point will position itself correctly at all times.

✓ Tight space

In many cases the BLP is attached where space is very limited. The BLP is designed take up very little space to avoid touching other parts than the base of which it is attached.

✓ Sensitive load surface

Many times our Lifting Points are used on both sensitive and expensive equipment. To avoid any damage over time the BLP has added distance between the ring and the load which give plenty of space for a hook to fit in between without touching the surface.

Example of typical applications

- Handling of tools for pressing, molding and forging.
- Gearbox inspection in auto repair shop.
- Installation of finished panels in passenger lifts at construction site.
- Assembly of boat engines.
- Automobile assembly line.
- Production and handling of turbo machinery.

Ball-bearing Lifting Point BLP

Art. no.	Code	B	C	D	Dimensions in mm						Weight kgs
					L	L1	M	X	Y	Z	
Z102008	BLP-M8 x 1.25	35	55	13	16	112	8	57	61	Ø42	0.6
Z102010	BLP -M10 x 1.5	35	55	13	20	112	10	57	61	Ø42	0.6
Z102012	BLP -M12 x 1.75	35	55	13	24	112	12	57	61	Ø42	0.6
Z102016	BLP-M16 x 2	35	55	13	30	112	16	57	61	Ø42	0.6
Z102020	BLP-M20 x 2.5	34	57	17	30	132	20	75	67	Ø59	1.3
Z102024	BLP-M24 x 3	50	70	17	36	145	24	75	84	Ø59	1.5
Z102030	BLP-M30 x 3.5	54	96	22	45	202	30	106	99	Ø74	3.4
Z102036	BLP-M36 x 4	54	96	22	54	202	36	106	99	Ø74	3.5
Z102042	BLP-M42 x 4.5	70	120	28	63	242	42	122	127	Ø93	6.5
Z102048	BLP-M48 x 5	70	120	28	72	242	48	122	127	Ø93	6.8

BLP with UNC thread

Art. no.	Code	B	C	D	Dimensions in mm						M inch	Weight kgs
					L	L1	X	Y	Z			
Z102108	BLP-5/16"-18 UNC	35	55	13	16	112	57	61	Ø42	5/16"	0.6	
Z102110	BLP-3/8"-16 UNC	35	55	13	20	112	57	61	Ø42	3/8"	0.6	
Z102112	BLP-1/2"-13 UNC	35	55	13	24	112	57	61	Ø42	1/2"	0.6	
Z102116	BLP-5/8"-11 UNC	35	55	13	30	112	57	61	Ø42	5/8"	0.6	
Z102120	BLP-3/4"-10 UNC	34	57	17	30	132	75	67	Ø59	3/4"	1.3	
Z102121	BLP-7/8"-9 UNC	34	57	17	30	132	75	67	Ø59	7/8"	1.3	
Z102124	BLP-1"-8 UNC	50	70	17	38	145	75	84	Ø59	1"	1.5	
Z102130	BLP-1 1/4"-7 UNC	54	96	22	48	202	106	99	Ø74	1 1/4"	3.4	
Z102136	BLP-1 1/2"-6 UNC	54	96	22	57	202	106	99	Ø74	1 1/2"	3.6	
Z102142	BLP-1 3/4"-5 UNC	70	120	28	67	242	122	127	Ø93	1 3/4"	6.6	
Z102148	BLP-2"-4.5 UNC	70	120	28	76	242	122	127	Ø93	2"	7.0	

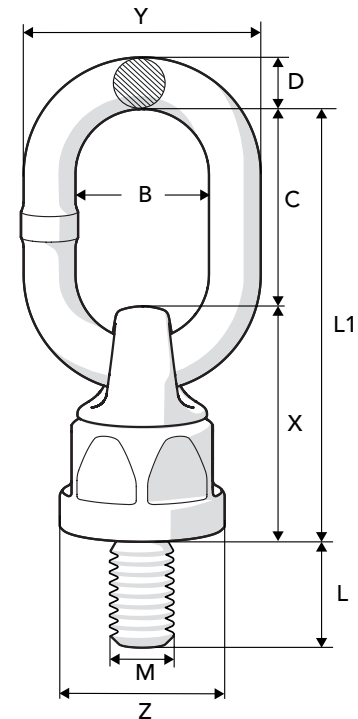

Working Load Limits* - BLP

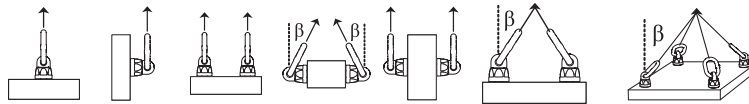

No. of legs	1	1	2	2	2	2 symmetric	3 & 4 symmetric	Tightening torque	Spanner size		
Angle β	0°	90°	0°	0-45°	90°	0-45°	45-60°	0-45°	45-60°		
BLP -M8 x 1.25	0.6	0.3	1.2	0.4	0.6	0.4	0.3	0.6	0.45	10 Nm	36 mm
BLP -5/16"-18 UNC	0.6	0.3	1.2	0.4	0.6	0.4	0.3	0.6	0.45	7 Ft.Lbs	1 1/2"
BLP -M10 x 1.5	1.2	0.6	2.4	0.8	1.2	0.8	0.6	1.3	0.90	15 Nm	36 mm
BLP -3/8"-16 UNC	1.0	0.5	2.0	0.7	1.0	0.7	0.5	1.1	0.75	11 Ft.Lbs	1 1/2"
BLP -M12 x 1.75	1.5	0.75	3.0	1.1	1.5	1.1	0.75	1.5	1.1	27 Nm	36 mm
BLP -1/2"-13 UNC	1.5	0.75	3.0	1.1	1.5	1.0	0.75	1.5	1.1	20 Ft.Lbs	1 1/2"
BLP -M16 x 2	3.0	1.5	6.0	2.1	3.0	2.1	1.5	3.1	2.2	60 Nm	36 mm
BLP -5/8"-11 UNC	3.0	1.5	6.0	2.1	3.0	2.1	1.5	3.1	2.2	44 Ft.Lbs	1 1/2"
BLP -M20 x 2.5	5.0	2.5	10.0	3.5	5.0	3.5	2.5	5.2	3.7	90 Nm	50mm
BLP -3/4"-10 UNC	4.5	2.25	9.0	3.1	4.5	3.1	2.25	4.7	3.3	66 Ft.Lbs	2"
BLP -7/8"-9 UNC	6.0	3.0	12.0	4.2	6.0	4.2	3.0	6.3	4.5	66 Ft.Lbs	2"
BLP -M24 x 3	7.0	4.0	14.0	5.6	8.0	5.6	4.0	8.4	6.0	135 Nm	50mm
BLP -1"-8 UNC	7.0	4.0	14.0	5.6	8.0	5.6	4.0	8.4	6.0	100 Ft.Lbs	2"
BLP -M30 x 3.5	12.0	6.0	24.0	8.4	12.0	8.4	6.0	12.6	9.0	270 Nm	65 mm
BLP -1 1/4"-7 UNC	12.0	6.0	24.0	8.4	12.0	8.4	6.0	12.6	9.0	200 Ft.Lbs	2 5/8"
BLP -M36 x 4	14.0	8.0	28.0	11.2	16.0	11.2	8.0	16.8	12.0	320 Nm	65 mm
BLP -1 1/2"-6 UNC	14.0	8.0	28.0	11.2	16.0	11.2	8.0	16.8	12.0	236 Ft.Lbs	2 5/8"
BLP -M42 x 4.5	16.0	10.0	32.0	14.0	20.0	14.0	10.0	21.0	15.0	600 Nm	85 mm
BLP -1 3/4"-5 UNC	16.0	10.0	32.0	14.0	20.0	14.0	10.0	21.0	15.0	440 Ft.Lbs	3 1/8"
BLP -M48 x 5	18.0	13.0	36.0	18.2	26.0	18.2	13.0	27.3	19.5	800 Nm	85 mm
BLP -2"-4.5 UNC	18.0	13.0	36.0	18.2	26.0	18.2	13.0	27.3	19.5	590 Ft.Lbs	3 1/8"

* Safety factor 4:1